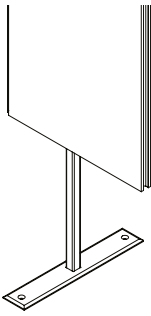
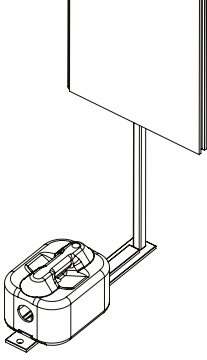
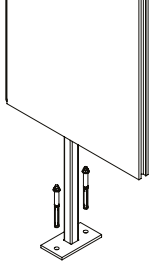

The Hoardfast system has a range of supports depending on your project requirement; from free-standing with multiple stability options to floor-to-ceiling fix.

Some panels are only available with a **specific support option**, see below...

Support Type	Support Specification	Used With: Panel	Used With: Panel Height
Equal (free-standing)	 <ul style="list-style-type: none"> • Self supporting up to 2.7m high • Support inserts into hollow flute of the panel • Support protrudes each side of panel by 210mm* 	Standard uPVC	1.12m / 2.25m / 2.7m
Offset Weighted (free-standing)	 <ul style="list-style-type: none"> • For additional stability up to 2.7m high • Allows up to 3 x 16kg weights to be installed per support • Support inserts into hollow flute of the panel • Weights are secured with a bolt, washer and wingnut • Support protrudes one side of panel by 600mm (construction side)* 	Standard uPVC	1.12m / 2.25m / 2.7m
Bolt Down (free-standing)	 <ul style="list-style-type: none"> • For a more stable and permanent solution up to 2.7m high • Can be secured to the floor • The support inserts into the hollow flute of the panel 	Standard uPVC	1.12m / 2.25m / 2.7m

*based on use with 35mm thick panel

Support Type

Support Specification

**Used With:
Panel**

**Used With:
Panel Height**

**Universal
(free-standing)**

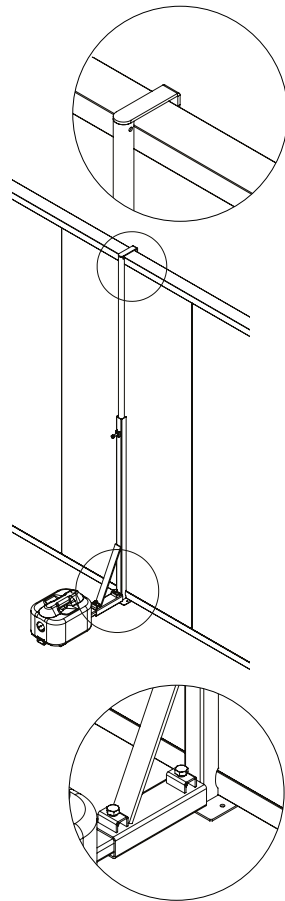

- Self supporting up to 2.7m high
- Support inserts into hollow flute of the panel
- Support protrudes each side of panel by 210mm*

Standard uPVC

2.25m / 2.7m / 3m

Soundscreen

2.25m / 2.7m / 3.1m

Firescreen

2.25m / 2.7m / 3.1m

Flamescreen

2.25m / 2.7m

Floor-to-ceiling

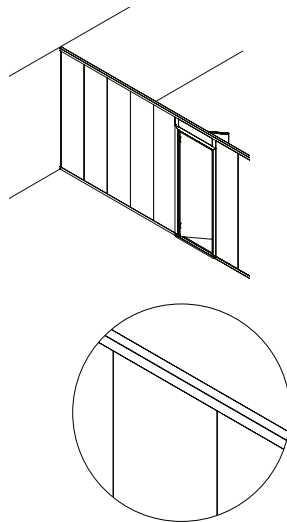

- For maximum stability
- Free-standing up to 3.1m high
- Standard: allows up to 3 x 16kg weights per support (Protrudes 645mm construction side)
- Long: will accommodate up to 6 x 16kg weights per support (Protrudes 900mm construction side)
- System secured at base using a hooked in u-channel and at the top using a hooked over pole

Budget PVC

1.12m / 2.25m / 2.7m

Standard uPVC

1.12m / 2.25m / 2.7m

Soundscreen

1.12m / 2.25m / 2.7m

Firescreen

1.12m / 2.25m / 2.7m

Flamescreen

1.12m / 2.25m / 2.7m

This fact sheet is for illustrative purposes only and based on the latest information at the time of print. Installation methods may vary depending on specific project requirements. Westgate Global reserve the right to make changes at any time without notice.